

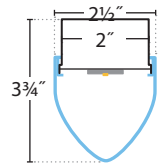

Type:

Job:



**Sleek and streamlined with a touch of retro style.**

Minimalist and Machine-Age inspired, this aerodynamic spin on our ever-popular Snap offers a subtle retro nod without being 'themey.'

It has a timeless appeal that spans everything from the Art Deco era through today's prevalent return of the mid-century modern aesthetic.

**AERO-LED35-LO-SAL**  
2130 Delivered Lumens  
18 Watts  
120 lm/w

UP TO **120** LM/W

|       |     |     |      |
|-------|-----|-----|------|
|       | LO  | MO  | SO   |
| lm/ft | 530 | 650 | 1000 |
| w/ft  | 4.2 | 5.5 | 9    |

[CLICK HERE](#)



Lumen output may vary +/- 5%  
3500K used for lm/ft estimates above  
4000K +2% IIf, 3000K -2%, 2700K -4%  
-10% LLF for 90 CRI (4K, 3500K and 3K)

See LED Details PDF for more info

| SE-RIES   | LED COLOR  | OUT-PUT  | NOMINAL LENGTH   | SHIELD-ING                      | COLOR/FINISH  | VOLT-AGE  | MOUNT-ING   | CEILING SYSTEMS  | DRIVERS  | OPTIONS & SENSORS   |   |
|-----------|--|--|--|---------------------------------|---|---|---|--|--|---|---|
| AERO      |  |  |  |                                 |   |   |   |  |  |   |   |
| Snap-Aero | LED27 2700K (90CRI)<br>LED3 3000K<br>LED35 3500K<br>LED4 4000K<br>LED3-90 90CRI<br>LED35-90 90CRI<br>LED4-90 90CRI | LO Low<br>MO Medium<br>SO Standard<br>PROG Programmable Light Output (Specify desired lm/ft or w/ft) | 2'<br>3'<br>4'<br>6'<br>8'<br>R____ (Row length in 1' increments)<br>SML Sym-metric Row Length | SAL Satin Acrylic (WA Lens N/A) | TMW Textured Matte White<br>YGW Gloss White (Standard)<br>Y____ Premium Color<br>CC Custom Color<br><b>NOTE:</b> All canopies are painted the same color as the fixture, specify canopy color after fixture (i.e. YPE-TMW for white canopies) | UNV (120-277)<br>347 (Emergency battery requires a Step Down transformer) | SUR Surface or Wall Mount<br>CA48", 96" or 144" Aircraft Cable (Adjustable) | X1 T-Bar 1 5/16" or 9/16"<br>X3 Hard Ceiling<br>X6 Slot Grid | ND Non-Dimming<br>DM10 0-10v, 10% Dimming (Standard)<br>DM01 0-10v, 1% Dimming<br>STEP Step Dimming, 100-50-Off, Osram<br><b>NOTE:</b> Lumens and watts per foot may differ for STEP drivers, consult factory<br>LDE5 5-Series EcoSystem LED<br>LDE1 Hi-lume 1% EcoSystem LED (Soft fade on, fade-to-black dimming)<br>LTE Hi-lume 1% 2-wire LED Driver (120V forward phase only)<br>* NA with HO<br>ECO 1% 0-10v, EldoLED<br>ECDA 1% DALI, EldoLED<br>SOLO 0.1% 0-10v, EldoLED (Dim to Dark)<br>SODA 0.1% DALI, EldoLED (Dim to Dark) | EML* Emergency Battery, Low (850 delivered lumens)<br>EMH* Emergency Battery, High (1175 delivered lumens)<br>*4' or longer (remote for < 4')<br>EBCP1G Single Gang<br>EBCP2G Dual Gang (Electrical Box Cover Plate/ Mud Ring)<br><b>SENSORS:</b><br>205† WattStopper PIR Occupancy<br>205-ND: On/off<br>205-DM: Dim to 10% / 1%<br>205-STEP: Dim to 50%<br>505 WattStopper Ultrasonic Occupancy (SUR on wall mount only, N/A galvanized)<br>505-STEP: Dim to 50%<br>505-DM: Dim to 10% | TRS Tamper-Resistant Screws<br>PRUBIN Meticulous Binning and Labeling every LED Board within a 2-Step MacAdams Ellipse<br><br>LUX† Phillips DLH<br>ENL† Enlighted 2-Wire DLH & Environmental<br><br>† Adds 3' to fixture length |



**PHOTOMETRICS**

**Low Output:**  
**AERO-LED35-LO-SAL**  
 2130 Delivered Lumens  
 18 Watts  
 120 lm/w  
 Test  
 #103143275LAX-001

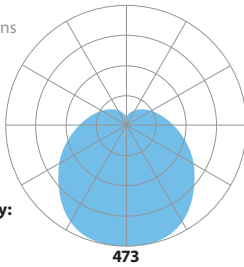

**Zonal Lumen Summary:**  
 0-90 = 84%  
 90-180 = 16%

| Vertical Angle | 0°  | 25° | 45° | 65° | 90° |
|----------------|-----|-----|-----|-----|-----|
| 0°             | 472 | 472 | 472 | 472 | 472 |
| 5°             | 473 | 473 | 470 | 471 | 470 |
| 15°            | 477 | 473 | 461 | 451 | 446 |
| 25°            | 479 | 468 | 439 | 413 | 400 |
| 35°            | 469 | 451 | 406 | 360 | 338 |
| 45°            | 447 | 422 | 361 | 297 | 266 |
| 55°            | 408 | 383 | 314 | 232 | 192 |
| 65°            | 352 | 329 | 264 | 171 | 123 |
| 75°            | 290 | 271 | 214 | 126 | 65  |
| 85°            | 229 | 214 | 166 | 89  | 20  |
| 90°            | 201 | 188 | 145 | 73  | 3   |
| 95°            | 176 | 164 | 125 | 60  | 2   |
| 105°           | 133 | 123 | 91  | 37  | 3   |
| 115°           | 99  | 90  | 63  | 22  | 3   |
| 125°           | 70  | 62  | 41  | 14  | 3   |
| 135°           | 46  | 40  | 25  | 9   | 3   |
| 145°           | 27  | 23  | 15  | 7   | 4   |
| 155°           | 15  | 13  | 8   | 5   | 4   |
| 165°           | 8   | 6   | 5   | 5   | 4   |
| 175            | 3   | 3   | 4   | 4   | 0   |

**LUMEN MAINTENANCE**

Designed to last with cool running mid-power LEDs projected to maintain 90% (L90) of their initial output for 100,000 hours (at HO), and L70 exceeding 150,000 hours.

**LED SYSTEM** LED modules and drivers are field replaceable.

**PROG (OPTIONAL)** Programmable light output. Specify desired lumens or watts per linear foot. Min: 2.5 w/ft, consult factory for requests above 12 w/ft.

**BINNING** Standard binning (all Prudential LED boards) includes testing at the chip level and board integration to provide consistent color temperature within a 3-step MacAdams ellipse, with +/- 5% lumen output range and +/- .004 Duv.

**PRUBIN\* (OPTIONAL)** Prudential Ltg's exclusive 'job binning' method that ensures color temperature consistency across all luminaires on a project. Meticulously testing and labeling **EVERY LED BOARD** to +/- 25 lumens, +/- 50k CCT and +/- .004 Duv — while also separating positive from negative — allows us to match color, hue and intensity throughout a project and provides a consistent color temperature within a 2-step MacAdams ellipse.

**LABELS** ETL damp labeled and I.B.E.W. manufactured.

**ELECTRICAL** Must specify LED dimming controls. LED fixtures have constant current driver(s) with less than 20% THD when loaded to a minimum of 60%. Drivers sink a maximum of 6mA per driver. DM10 LED drivers are 0-10V dimmable and are compatible with most 0-10V wall slide dimmers and direct 0-10V analog signal dimmers. Max driver size 1.65" w x 1.25" h.

**CONSTRUCTION**

**Housing** Die-formed 22-gauge steel, >20% PC recycled, 100% recyclable.

**End Plates** Spring-fastened aluminum, >25% PC recycled, 100% recyclable.

**Lens** Single-piece (up to 8' lengths) extruded acrylic, 100% recyclable.

**Weight** 2 lbs/ft.

**MOUNTING** Surface mounted to walls or ceilings or suspended by cable.

**WARRANTY** Single-source, 5 year limited warranty covers standard components and construction.



### ADJOINING DETAIL

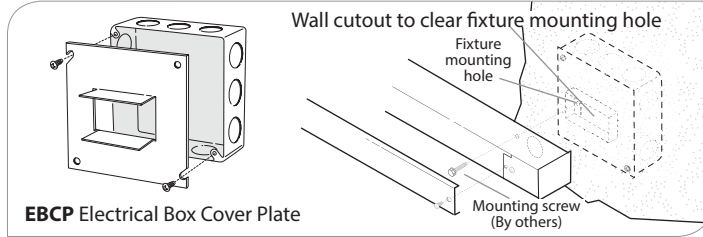
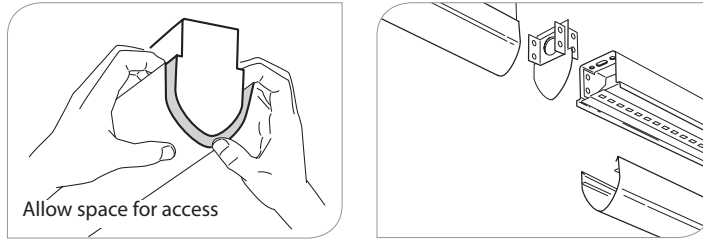

**OPTIONAL ELECTRICAL BOX COVERS**  
7/8" Dia. K.O. will accommodate 2"x4" or 4"x4" J-Box

### CONTROL SENSORS



**NOTE:** Small cut-out of lens around sensor, Surface mount on walls only



**NOTE:** Adds 3" to length, 3E: enlightened control module required

Choose from one of our Premium Colors with no set-up fee.

For paint chip samples, please email: [info@prulite.com](mailto:info@prulite.com)

### MOUNTING LOCATIONS

- ⊕ Cable mount
- Surface mount
- ⊕ 7/8" Dia. K.O.
- 1 1/16" K.O. / Stem & powerfeed

3" Sensor module added to fixture length for 205, LUX and 3E, end of run or between fixtures

